

7/2/2024 10:54 AM C:\Users\Cfrenhan\OneDrive\Arduro\nc\776-002\Project Files\03-Prop\03-Dwg\776002-PM-AGP.dwg

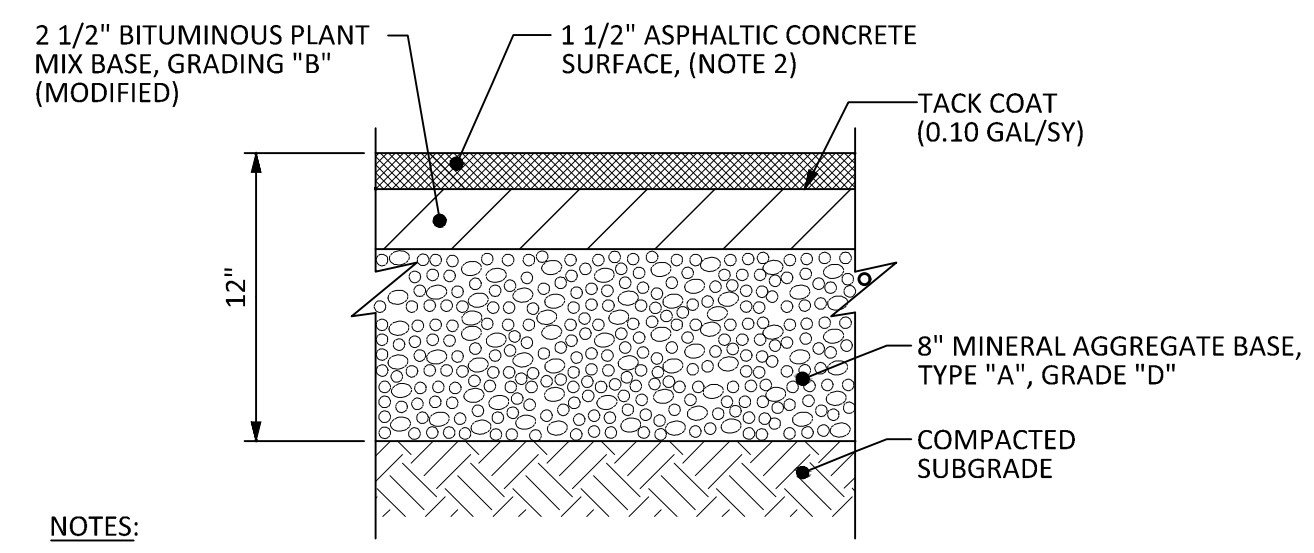

NOTES:
 PAVEMENT HAS NOT BEEN DESIGNED FOR CONSTRUCTION TRAFFIC/ACTIVITIES. USE OF THESE SURFACES FOR CONSTRUCTION ACTIVITIES SHALL BE DONE AT THE CONTRACTOR'S CONVENIENCE AND RISK. DAMAGE TO PAVEMENT RESULTING FROM THESE ACTIVITIES SHALL BE REPAIRED IN CONFORMANCE WITH THE INITIAL PAVEMENT SPECIFICATIONS.
 ASPHALTIC CONCRETE SURFACE COURSE SHALL BE GRADE "E" MIX FOR ROADS WITH A SLOPE LESS THAN OR EQUAL TO 10%; FOR SLOPES GREATER, USE GRADE "D" MIX.

1 ASPHALT PAVEMENT SECTION
 C1.00 NTS

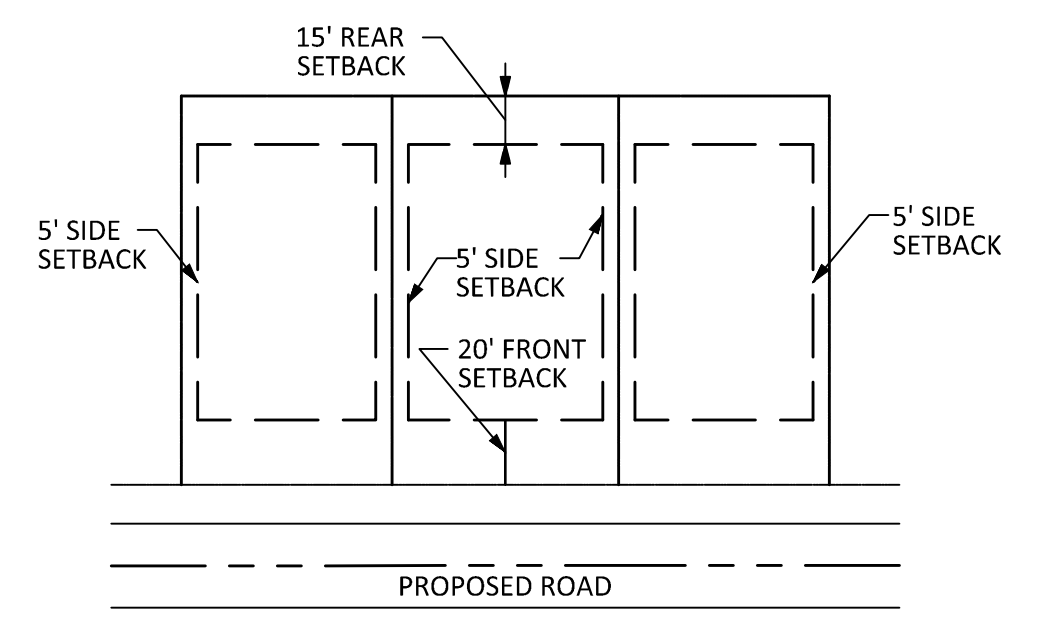

2 TYPICAL INTERIOR LOT
 C1.00 NTS

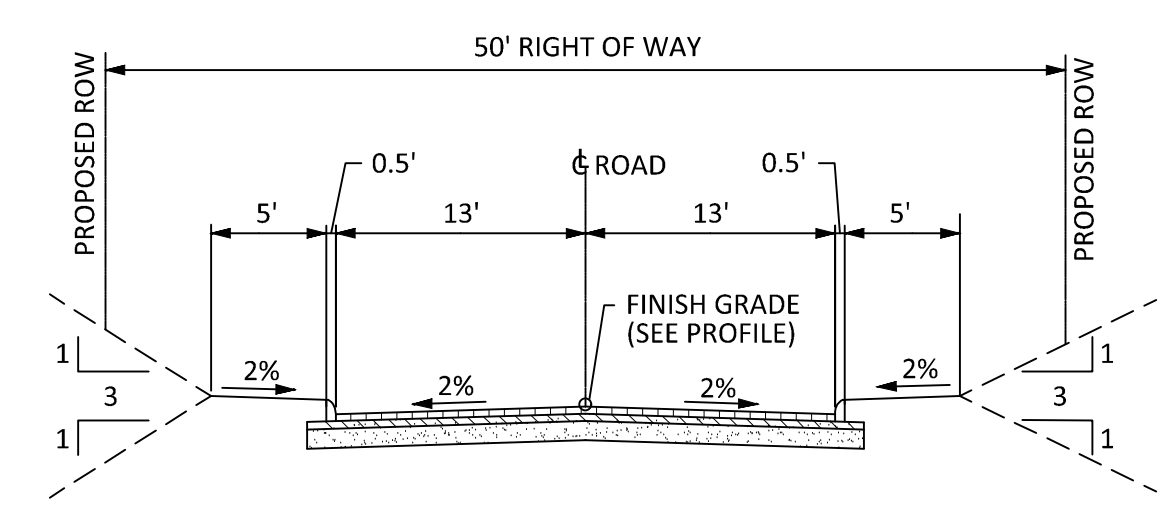

3 TYPICAL 50' ROW ROAD SECTION
 C1.00 NTS

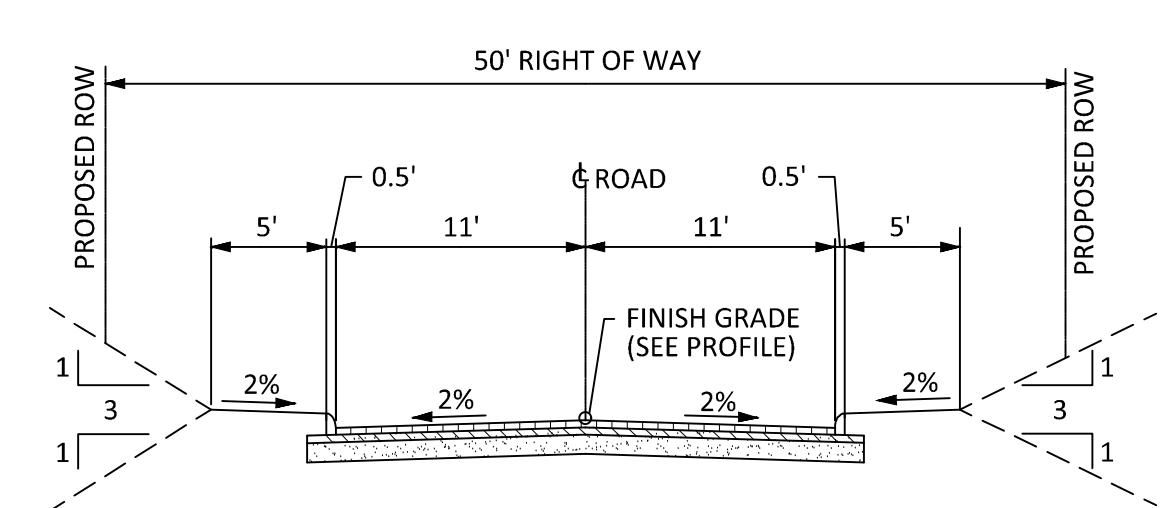

4 TYPICAL 22' ROAD SECTION
 C1.00 NTS

LEGEND:

- PROPOSED CONTOUR
- - - EXISTING CONTOUR
- PROPOSED PROPERTY/ROW LINE
- - - EXISTING PROPERTY LINE
- PROPOSED ROAD CENTER LINE
- - - 50' BUFFER FROM LARGEST CLOSED CONTOUR. REFERENCE GEOTECHNICAL REPORT FOR RECOMMENDATIONS
- 1090 EXISTING CONTOUR ELEVATION
- 1070 PROPOSED CONTOUR ELEVATION
- PROPOSED ASPHALT PAVEMENT
- HILLSIDE PROTECTION AREA
 TOTAL AREA ± 30.32 AC
 APPROXIMATE DISTURBED AREA ± 19.50 AC.

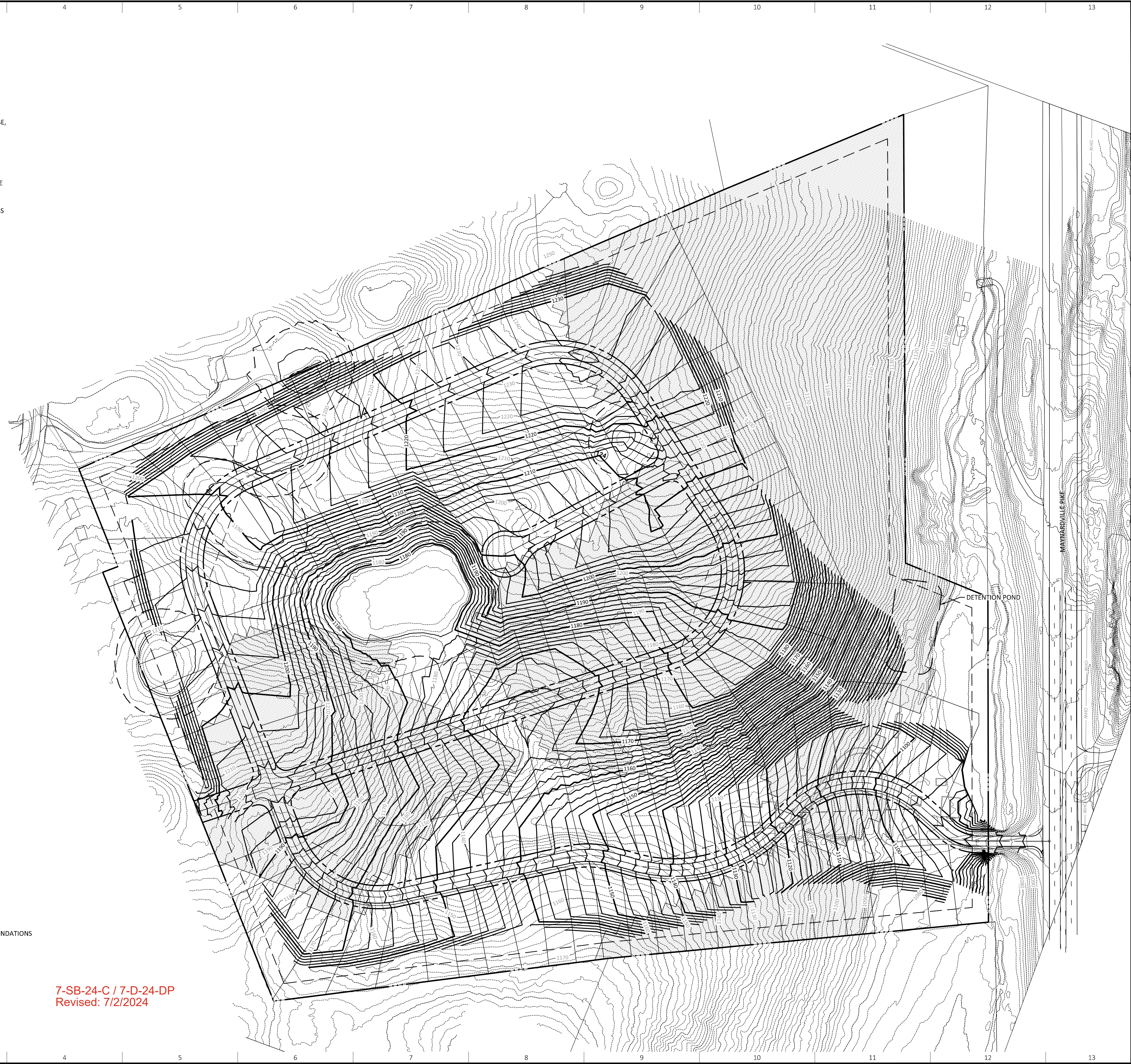

7-SB-24-C / 7-D-24-DP
 Revised: 7/2/2024

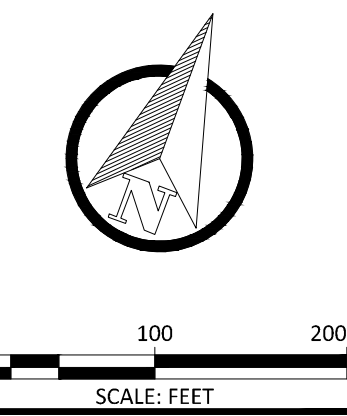

ARDURRA
 COLLABORATE. INNOVATE. CREATE.
 2160 Lakeside Centre Way, Suite 201
 Knoxville, TN 37922
 Phone: (865) 690-6419
 www.Arduro.com

HERITAGE LAND DEVELOPMENT PARTNERS, LLC
 3571 LOUISVILLE ROAD
 LOUISVILLE, TN 37777

CONNOR KELLY
 CKELLY@CBH.EMAIL
 865-851-7373

| NO. | DATE | BY | REVISION |
|-----|------|----|----------|
| | | | |
| | | | |
| | | | |
| | | | |

MAYNARDVILLE PIKE SUBDIVISION
 7933 MAYNARDVILLE PIKE (PARCEL 029 001)
 KNOXVILLE, TN 37938

CONCEPT GRADING PLAN
 PLANNING FILE NUMBERS: 7-SB-24-C/7-D-24-DP



JOB NO: 776-002
 DATE: 6/24/24

C1.00
 CONCEPT PLAN

